

Cobra Expo

Modular exhibition system



Rund Uprights
Ø44mm Uprights



Cross rails
50mm or 150mm cross rails

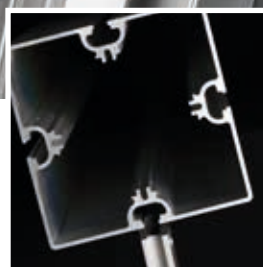

MEGA
Profiles with a strong presence

SYSTEM
STANDEX®

Direct method of supply

System Standex design, develop and manufacture all exhibition and display systems in house. We supply direct from our factory to our customers.

From our central production facility we manage the process from design to delivery – working closely with our customers to ensure a high quality cost effective product delivered on time

System Standex offer full production services including cutting – drillings – machining – bonding – powder coating – joinery and distribution.

We offer our profiles and jointing systems in a format to match your demands – as components or as a part or complete assembly.

System Standex have been involved in design and manufacture of aluminium frames for more than 50 years.

During this time we have developed systems for many industries and have established markets in

- exhibition and display
- shop fitting and visual merchandising
- museum displays including high security showcases
- machine guards – frames – partitions – enclosures

This brochure illustrates some of products we supply to the display industry. There is much more. Contact our experienced sales team to find out more.



A flexible system

– can be linked and combined in many configurations

Examples of construction with Cobra Expo and MEGA	5
Cobra Expo.....	6-7
Modular sizes and uprights.....	8
Cross rails and decorative panels	9
Accessories, Cobra Expo	10-11
MEGA	12-13
Profiles and connections	14
Accessories, MEGA	15
Special fixing with Cobra Expo	16
Technical floor	17
Examples of stand constructions	18-19
Shell schemes and accessories.....	20
Displays with textile graphics.....	21
Modular lengths and panel sizes for Cobra Expo	22
Other brochures.....	23



Cobra Expo exhibition stand



Storage room and counter constructed in Cobra Expo



Cobra Expo exhibition stand



Showroom made from MEGA



Cobra Expo exhibition stand



Cobra Expo as shell scheme



Cobra Expo exhibition stand



Cobra Expo exhibition stand

Cobra Expo

Classic exhibition construction system with uprights and cross rails to take panels. Modular stand builds and shell scheme system.



▲ Fittings for glass panels

◀ Decorative profiles

Constructed with uprights and cross rails and to take panels with and without graphics – Cobra Expo is a classic and robust construction system. The modular format makes design and build easy – plus a wide range of interchangeable accessories.

Imaginative ideas

- easy to create



Round uprights with 8, 6, or 4 channels

Uprights and cross rails are important basic components of Cobra Expo. Their circular shape produces an attractive design and numerous creative opportunities. Uprights are available in 8, 6 or 4 channel versions which allow you to design stands with a wide variety of angles that creates exciting and distinctive displays.



Range of colours

Cobra Expo is available with a silver-anodised finish or in a range of colours to suit your design. System Standex offers an in house powder coating service using the RAL range of colours.



Quality finish

Cobra Expo cross rails are fitted anywhere on the upright. The robust connectors on the cross rails expand when the Allen key is tightened. The cross rails are available in 50 or 150mm widths.



Room for creativity

You can design and create exciting and eye catching displays with individual design. Curved walls, ceiling and sections – system creating your designs.

Develop your stand

Cobra Expo takes practical details into account. Your exhibition stand can be constantly developed and revised using existing and addition system – and by combining it with other systems from System Standex.

Cobra Expo

Modular sizes

Dimensions are centre to centre of upright.

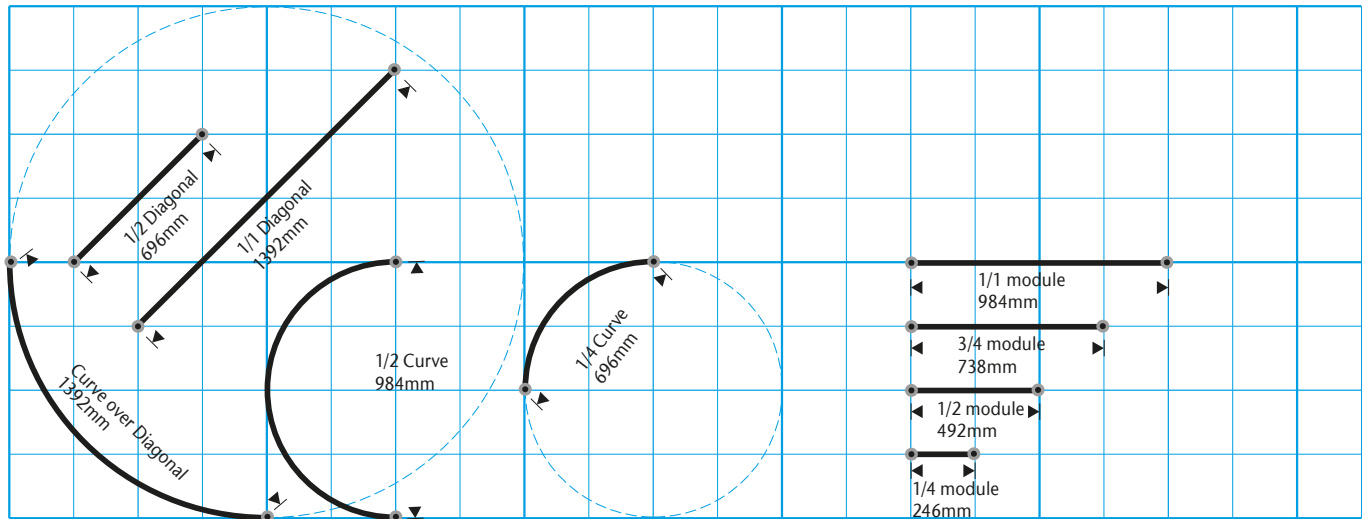

The module sizes are to modular lengths of 984mm between the centre of uprights. This ensures that there is room for complete modules in a stand which has been measured in full metres. Cross rail lengths are to the module sizes. Panels are cut in modular size -32mm to fit into the system. Read more about panel sizes on page 22. The system can be supplied in other modular sizes according to specification.

Uprights

Uprights available with 8, 6 or 4 channels. Uprights are supplied with an adjustable foot. The uprights can also be produced in specific lengths.

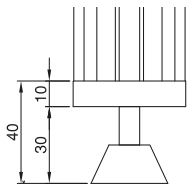

Complete 8 channel upright with foot
Lengths in mm

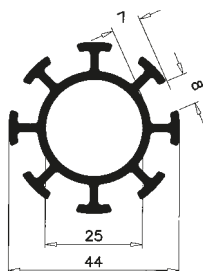
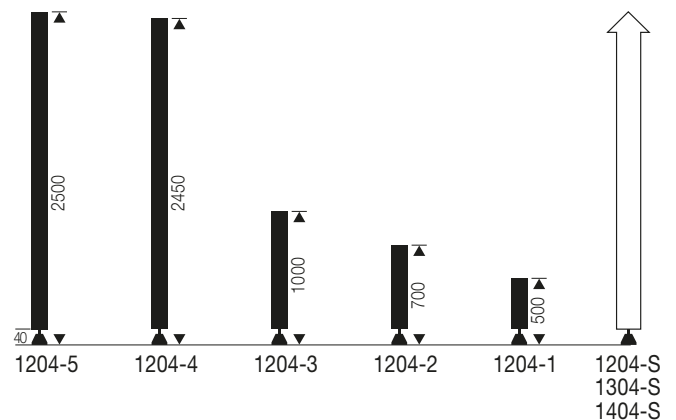

8 channel upright
with adjustable foot

1204-1 500mm
1204-2 700mm
1204-3 1000mm
1204-4 2450mm
1204-5 2500mm
1204-S In specific lengths.

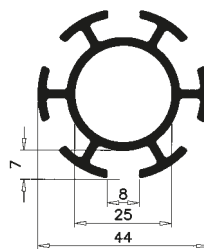

6 channel upright
with adjustable foot

1304-S In specific lengths.

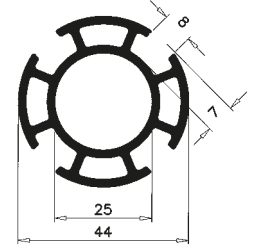

4 channel upright
with adjustable foot

1404-S In specific lengths

If you want to cut and mounting uprights and cross rails : See page 9.

Cobra Expo

**SYSTEM
STANDEX®**

Cross rails

Cross rails are available in widths of 50 or 150mm. They are supplied pre-fitted with joints and connectors in standard module size starting with 1/4 module and up to full diagonal.



50mm cross rail

Pre-fitted with joints and connectors

- 1201-1 1/4 module
- 1201-2 1/2 module
- 1201-3 3/4 module
- 1201-4 1 module
- 1201-7 2 modules
- 1201-8 3 modules
- 1201-9 4 modules
- 1201-10 5 modules
- 1201-6 1/2 modul diagonal
- 1201-5 1 modul diagonal
- 1201-S In specific sizes



Curved 50mm cross rail

Pre-fitted with joints and connectors

- 1202-1 1/4 curve
- 1202-2 1/2 curve
- 1202-3 Diagonal curve
- 1202-S Curves in specific designs

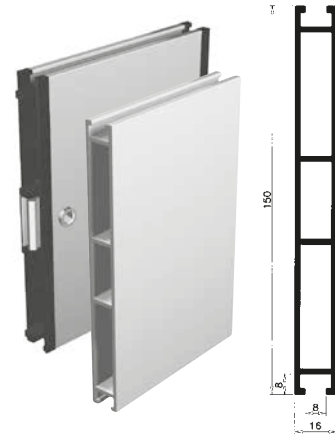

150mm cross rail

Pre-fitted with joints and connectors

- 1200-1 1/4 module
- 1200-2 1/2 module
- 1200-3 3/4 module
- 1200-4 1 module
- 1200-7 2 modules
- 1200-8 3 modules
- 1200-9 4 modules
- 1200-10 5 modules
- 1200-6 1/2 module diagonal
- 1200-5 1 module diagonal
- 1200-S In specific sizes

Technical info

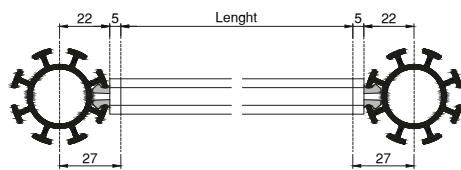

Cutting length of special lengths is 54 mm shorter than the distance between the module lines (27 mm on each side).

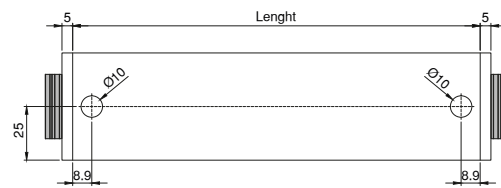

The connector holes are drilled exactly as shown.

Cobra Expo

Accessories

A comprehensive range of accessories that offer additional options to the system to produce the complete exhibition stand.

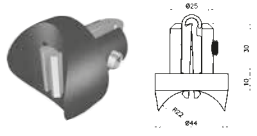

1105-20
Joint for assembly of
uprights/uprights, black

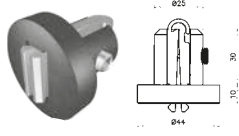

1105-21
Joint for assembly of
upright/cross rail, black



1108-9
Suspension fitting for
50mm cross rail.



1108-10
Suspension fitting for
150mm cross rail.



1108-1
Upright extension,
allow extra height. Also
a practical solution for
transport.



Cross rails can be fitted
horizontally on top of
uprights.

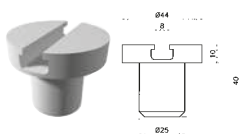

1105-22
Joint for fitting curves
to uprights, single.



Curved cross rails can
be fitted on top of uprights.

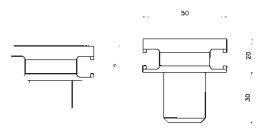

1106-11
Joint for e.g. ceiling
construction.

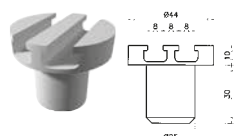

1105-23
Joint for fitting curves
to uprights, double.



1231
Suspension
fitting.



1231-1
Fitting with eye
bolt.



1105-30
Support for
wooden shelves
Grey nylon



1105-30G
Support for
glass shelves.
Grey nylon



1231-2-6x8
Eye bolt for
insert nut
GDS-711-M6



GDS-711-M5
Insert nut M5



GDS-711-M6
Insert nut M6



GDS-711-M8
Insert nut M8



1211
Shelf support.

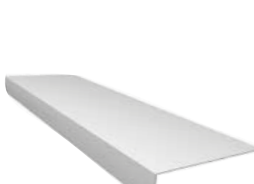

1210
Shelf, metal, White.



1213
Shelf support.



1212
Magazine shelf, metal,
White.



1105-16
Profile for fit-
ting of fabric
graphics.



1105-17
PVC profile
for fabric
graphics.



1216
Small coat
hook fitting.



1214
Suspension track for panels.



1215
1 module coat hook fitting.



1218
Suspension
fitting for graphic panels



1214-1 (right) / 1214-2 (left)
Corner suspension track for panels.

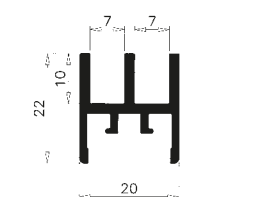

1105-13
Sliding door section in
5m length.

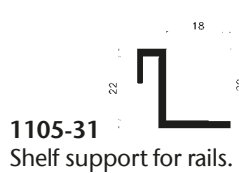

1105-31
Shelf support for rails.



1105-9
Fibre section.

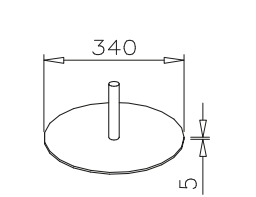

WSF-44
Base plate with pin.
Ø340mm

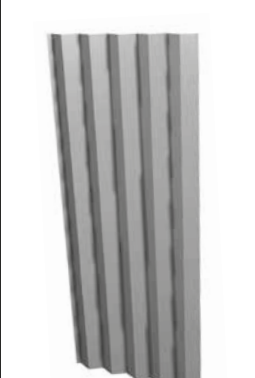

1225
Curtain.



1226-H / 1226-V
Side-hinged door.

Components required for the construction of an exhibition stand system

Design and create your own exhibition stand using Cobra Expo.
Profiles can be supplied in full lengths and fittings as required.
Please ask for further information on cutting, machining and assembly.

Uprights

8 channel uprights
profile only

- 1203-7 50mm
- 1203-1 150mm
- 1203-8 300mm
- 1203-2 460mm
- 1203-3 660mm
- 1203-4 960mm
- 1203-5 2410mm
- 1203-6 2460mm
- 1203-5 In specific lengths
- RC44-8 Full lengths of 5 m

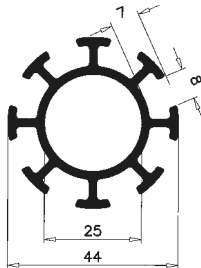

6 channel uprights
profile only

- RC44-6 Full lengths of 5 m
- 1303-5 In specific lengths.

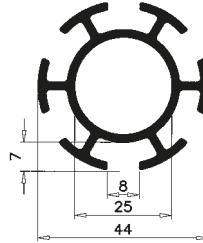

4 channel uprights
profile only

- RC44-4 Full lengths of 5 m
- 1403-5 In specific lengths.

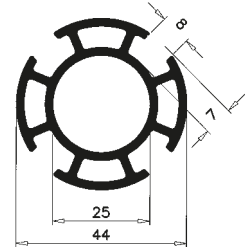

Upright accessories

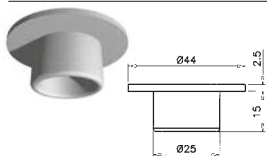

- 1105-1 Top plug for upright, black
- 1105-2 Top plug for upright, grey

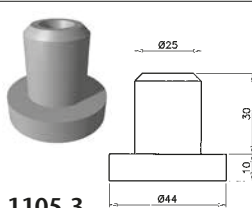

- 1105-3 Bottom plug for upright, black

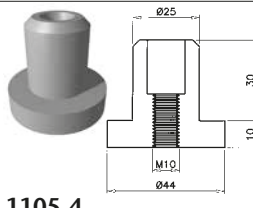

- 1105-4 Threaded bottom plug for upright, black

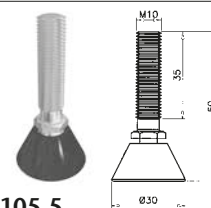

- 1105-5 Adjustable foot for bottom plug 1105-4, black

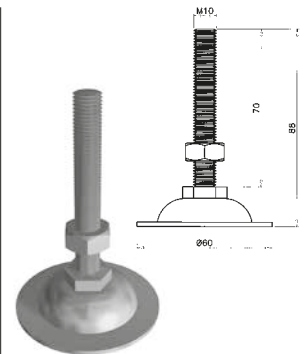

- 1105-6 Adjustable foot in steel for bottom plug 1105-4

Cross rails

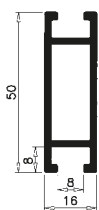

- 50mm unfitted

- RC44-5 Full lengths of 5 m.

- 150mm unfitted

- RC44-15 Full lengths of 5 m.

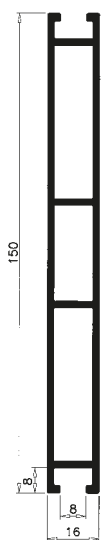

Accessories for cross rails

Connections for 50mm cross rails.

- 1106-5 Round for cross rail/upright, black nylon
- 1106-6 Round for cross rail/upright, grey nylon
- 1106-7 Flat for cross rail/cross rail, black nylon
- 1106-8 Flat for cross rail/cross rail, grey nylon

- 1108-6 Connector for 45° joint for 50mm cross rails, black nylon, rounded for cross rail/upright



- 1108-8 Connector for 30° joint for 50mm cross rails, black nylon, rounded for cross rail/upright

Connections for 150mm cross rails.

- 1106-1 Round for cross rail/upright, black nylon
- 1106-2 Round for cross rail/upright, grey nylon
- 1106-3 Flat for cross rail/cross rail, black nylon
- 1106-4 Flat for cross rail/cross rail, grey nylon



End plugs for 50mm cross rail.

- 1105-7 Black nylon
- 1105-8 Grey nylon

SKRUE-PC-M10x9
Screw for joint

PC44-5
Joint for 50 and 150mm cross rail

1108-5-H / 1108-5-V
45° Joint for 50mm cross rail

1108-7-H / 1108-7-V
30° Joint for 50mm cross rail

1105-15
Length wise joint for 50mm cross rail

1105-40
Allen key for joint

1105-41
Spec. Allen key for corner joints

1105-42
Ratchet with Allen key for joints

1105-12
Aluminium shelf support section, in 5 m length



MEGA PROFILE

Profiles with a strong visual presence. Designed to take panels and banners.
Modular stands or combined with other systems to add presence.



120x120 mm profile



Ø120 mm profile



80x80 mm profile

MEGA profiles provide a strong presence and they can be combined and linked with other systems from System Standex.

MEGA PROFILE

SYSTEM
STANDEX®

When the visual impact of the frame is all important

MEGA can be combined and linked with other systems from System Standex providing complete flexibility.



▲ The robust Mega profiles lend themselves to challenging designs and construction ideas.

◀ Impressive ceiling construction using MEGA.

MEGA PROFILE

Profiles

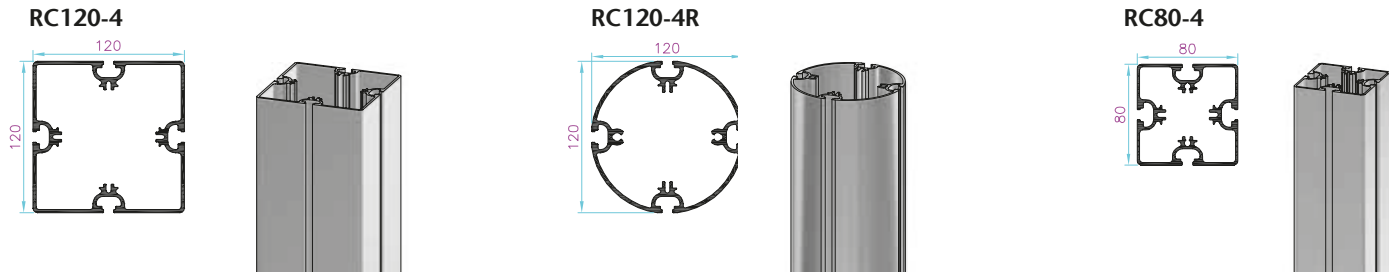

Connectors

For RC120-4:

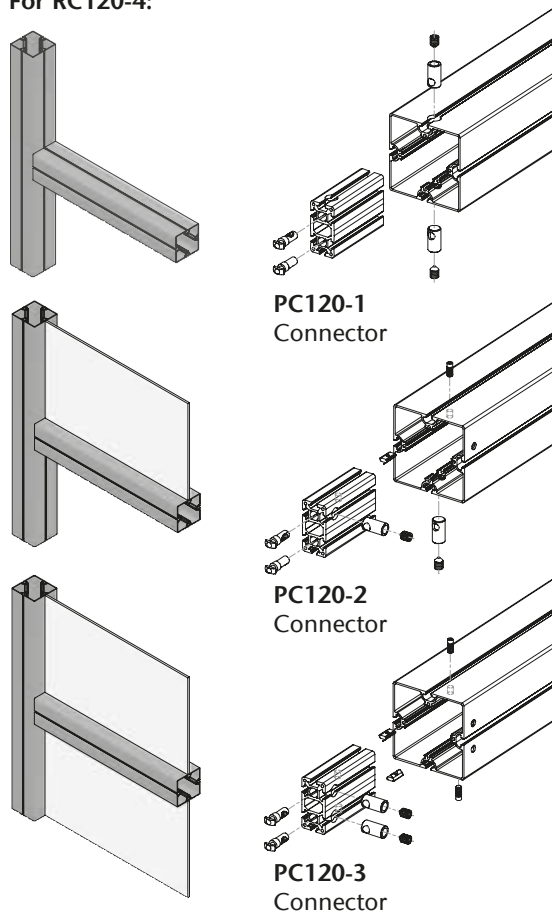

For RC80-4:

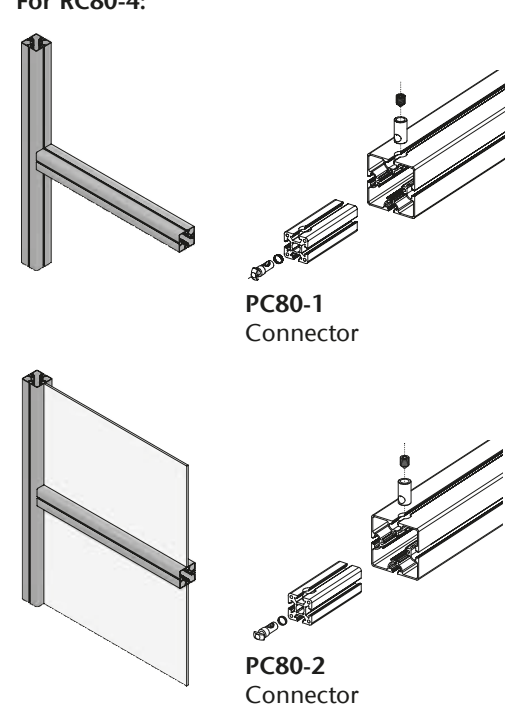

Straight connectors

For RC120-4:

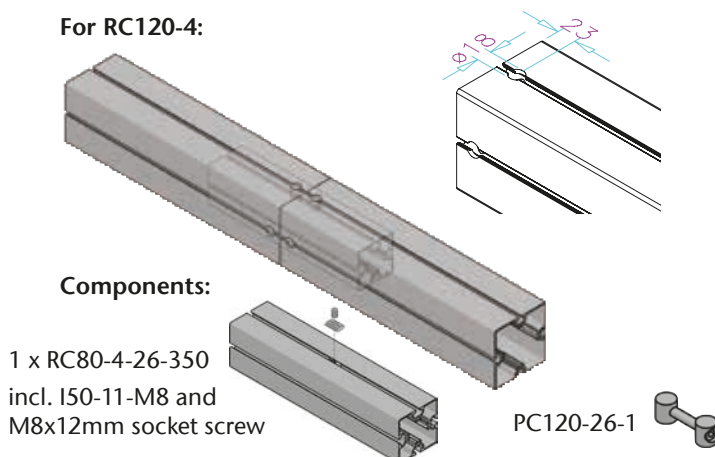

For RC80-4:

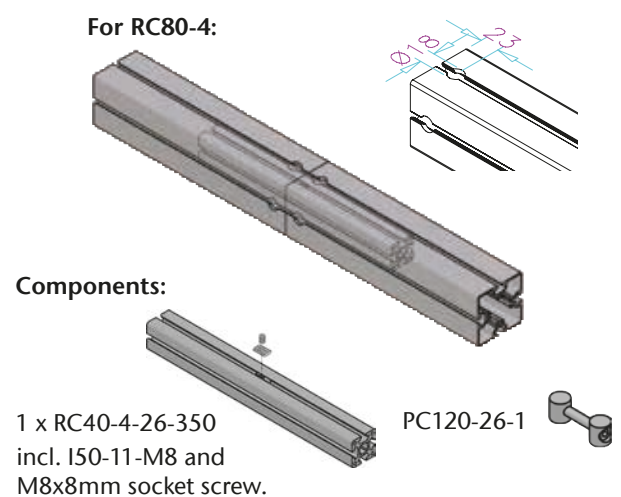

MEGA PROFILE

**SYSTEM
STANDEX®**

Connectors in variable lengths

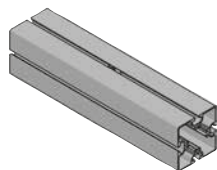

RC80-4-26-S
for RC120-4.
Variable length

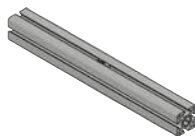

RC40-4-26-S
for RC80-4,
Variable length

Examples of use

Flexible connector for RC120-4

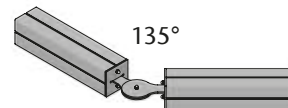
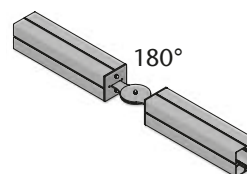
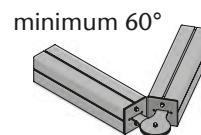
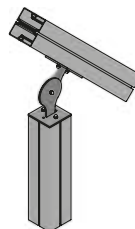
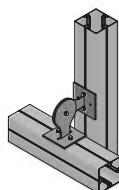

Flexible connections

For RC120-4:



PC120-25-2

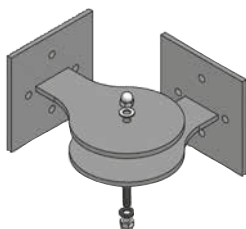

PC120-25-S

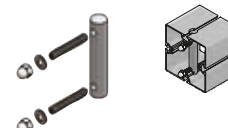
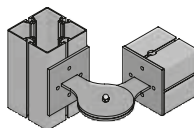

PC120-25-1

Accessories

WS-120-10
Banner holder
for Ø12mm profile.



RC12-1
Aluminium profile,
Ø12mm



1105-16
Profile for fabric.

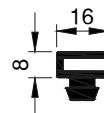

D10-M10
Levelling foot M10.



I50-11-31-1
Fitting with open M5
eye bolt.



I50-11-31-2
Fitting with closed
M5 eye bolt.



For RC120-4:

D120-4-6G/M10
Base plate with
threaded hole M10.



For RC120-4R:

D120-4R-6G/M10
Base plate with
threaded hole M10.



For RC80-4:

D80-4-6G/M10
Base plate with
threaded hole M10.

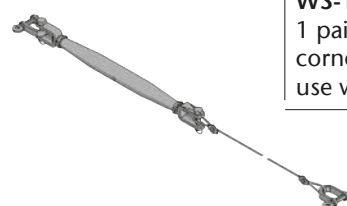

WS-120-2
Complete wire with turn-
buckle, specify length.

WS-120-1
1 pair of
corner plates for
use with WS-120-2.



D120-6
End cap.



D120-6R
End cap.



D80-6
End cap.

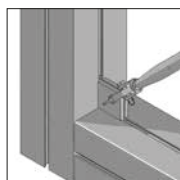

WSF-120-1
Base plate Ø340 mm
for RC120-4.



WSF-120-1R
Base plate Ø340 mm
for RC120-4R.



WSF-80-1
Base plate Ø340 mm
for RC80-4.



I50-4x5-200

Joining system to extend Mega profiles.



See other accessories for MEGA PROFILE page 20.

Special fixings with Cobra Expo

Fittings for glass panels.

Glass panels fitted to Cobra Expo give an impressive and individual design.

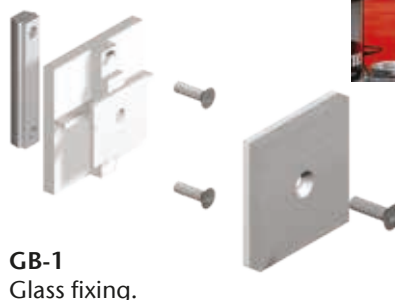
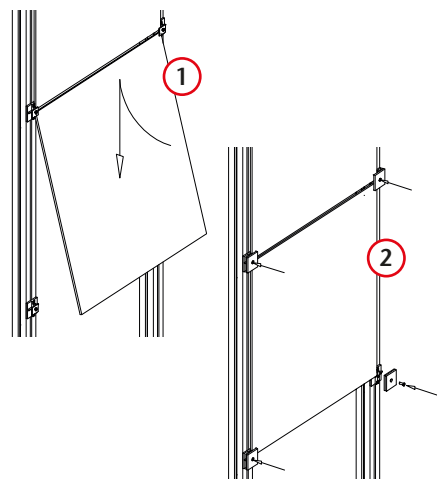

GB-1-R (right)
Glassfitting.

GB-1-L (left)
Glassfitting.



Cobra Wall

Cobra Wall conceals the frame giving a flat wall to display your graphic.



Detail of Cobra Wall seen from above.



VS-1
1 module



VS-2
1/2 module



VS-3
3/4 module



VS-4
1/4 module



VS-5
Special size module

Display with a fabric banner

Fabric banners are an economical method of presenting large (and small) scale graphics.

The fabric simply requires a hem top and bottom so as to take the cross rails. The banner will be stretched between the cross rail when fitted to the uprights.

The system can be used as a part of the exhibition stand or as a stand alone display. See more details on page 21.



Cobra Expo

**SYSTEM
STANDEX®**

Technical floor

A raised floor can increase the impact of your stand and products. Standex Technical Floor raises the floor 110mm and allows services to be hidden plus you can finish your floor with carpet or laminate as required.

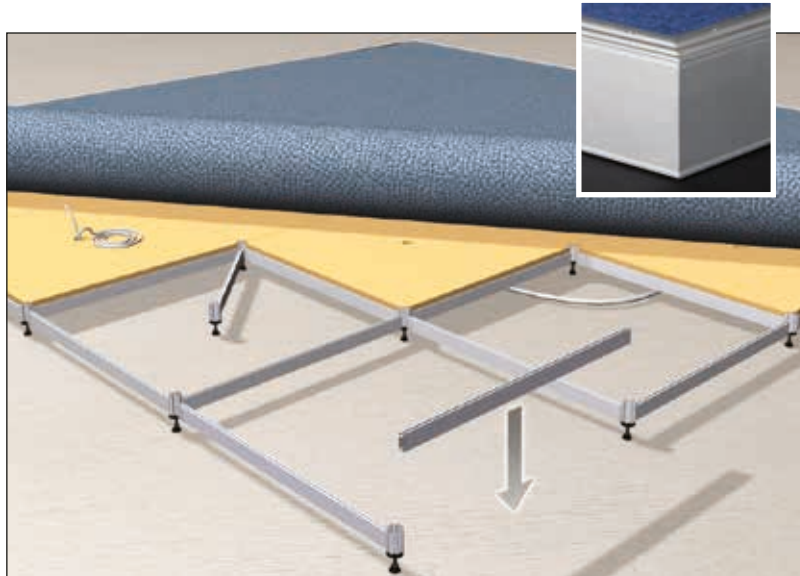

The system is based on, and is part of, the Cobra Expo exhibition stand system. It is easy to assemble – cross rails are fitted with joints that just slide into the uprights - no tools required. Technical floor height allows for cables and services to be hidden. Wheel chair ramps are available as required.

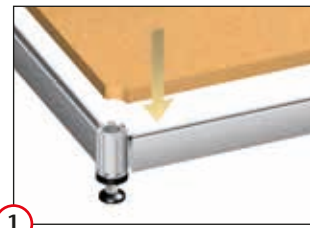



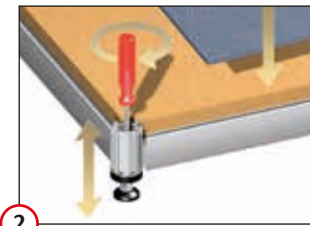

Uprights and cross rails assembled without tools. Panels locate and rest on the frame.

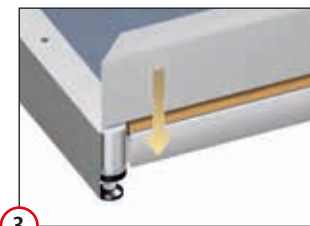







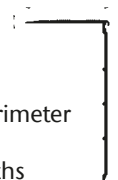
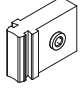

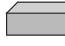

Adjust the up-rights as necessary – lay down the flooring.

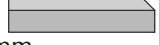
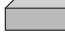

Fix the perimeter profile. This profile covers and protects the edge of the floor and can take graphics.

TG-1 Upright with adjustable foot	 TG-2 50mm cross rail, ½ module
	 TG-3 50mm cross rail, ½ module diagonal
 TG-5 22mm chipboard, 983x983mm	 TG-4 50mm cross rail, 1 module
 TG-52-103 100mm perimeter profile, in 5m lengths	 1106-12 Connector for TG-2, TG-3 og TG-4

100mm perimeter profile in standard modules		
	1 module	2 modules
Straight cut profiles	TG-6 L: 985mm 	TG-7 L: 1969mm 
Mitred left end	TG-15 L: 1011mm 	TG-9 L: 1995mm 
Mitred right end	TG-14 L: 1011mm 	TG-8 L: 1995mm 
Mitred both ends	TG-16 L: 1037mm 	TG-17 L: 2021mm 
Cut out for upright/back wall, left	TG-10 L: 1007mm 	TG-12 L: 1991mm 
Cut out for upright/back wall, right	TG-11 L: 1007mm 	TG-13 L: 1991mm 

Floor profile

GP-1
Aluminium profile
In 5m lengths or cut to length

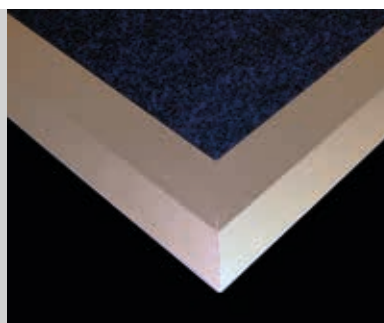
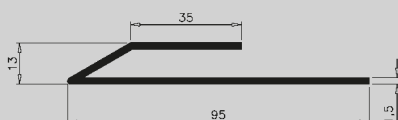

Exampels of stands constructions

Cobra Expo system is suitable for building small or large stands – only the sky is the limit.
The system is strong and easy to use.

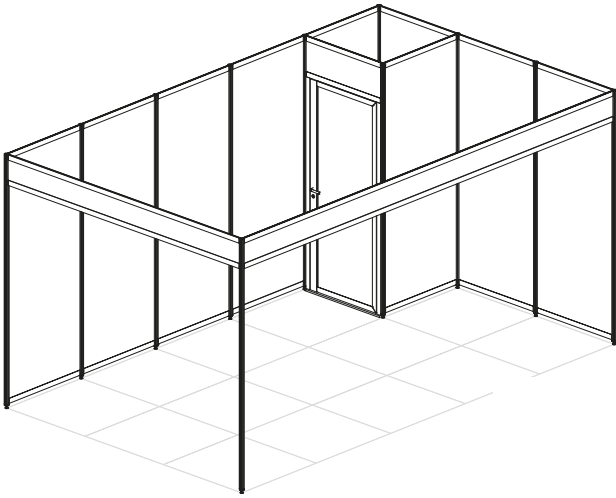

1

Corner stand

Corner stand with frieze and small storage room - 2 sides open.

2

Tall storage room

Storage room in a large stand can be build up to 4-5 meters high. Side-hinged door with lock.

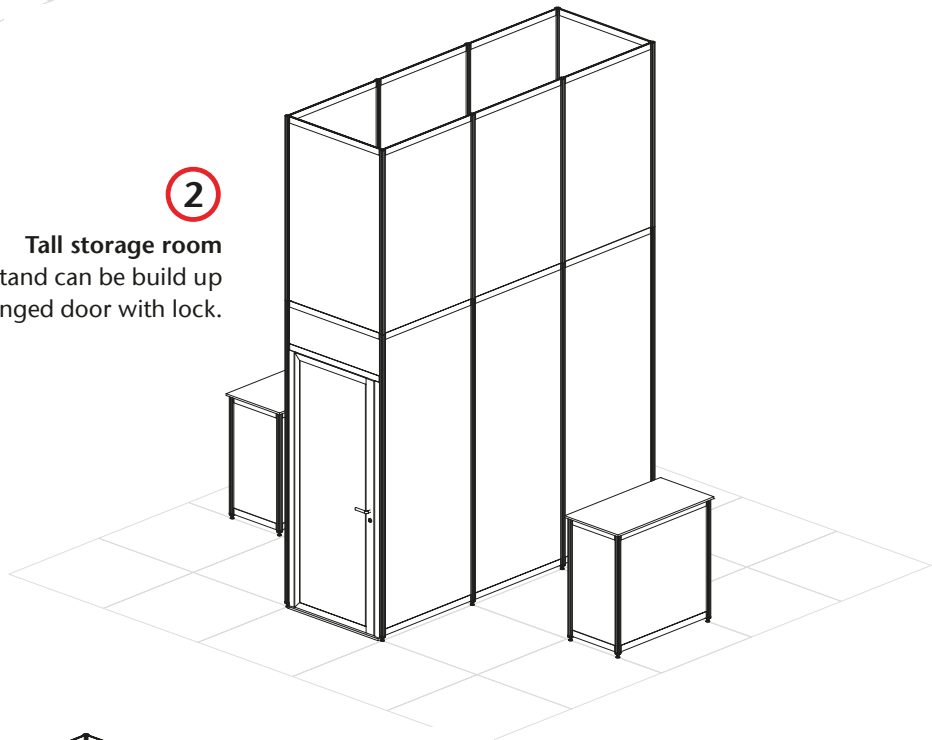

3

Stand with built-in glass display cases

Stand with glass display cases built-in and a storage room/kitchen.

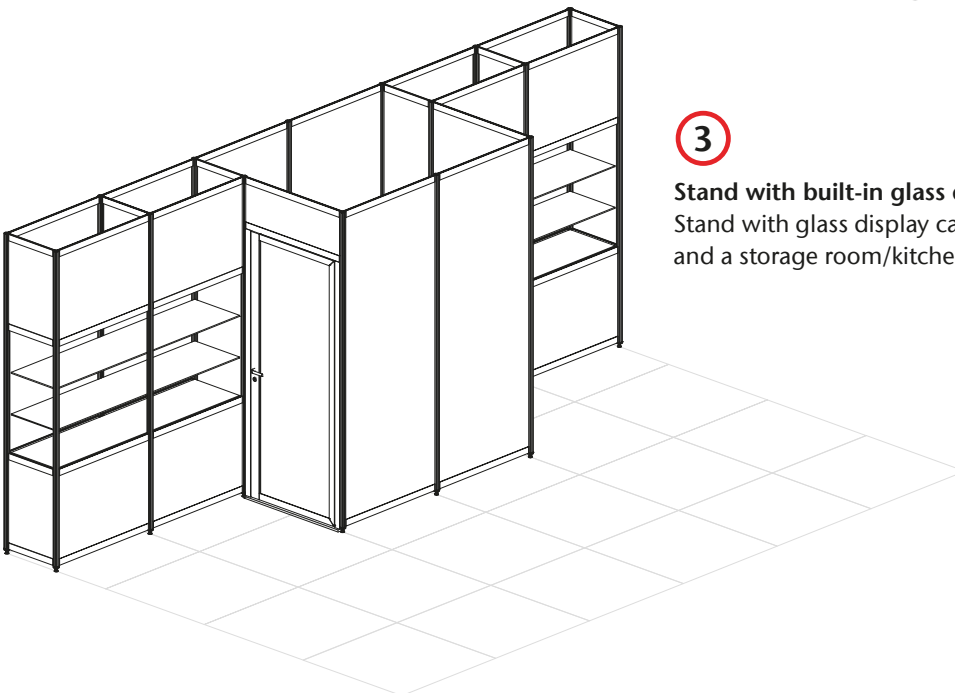

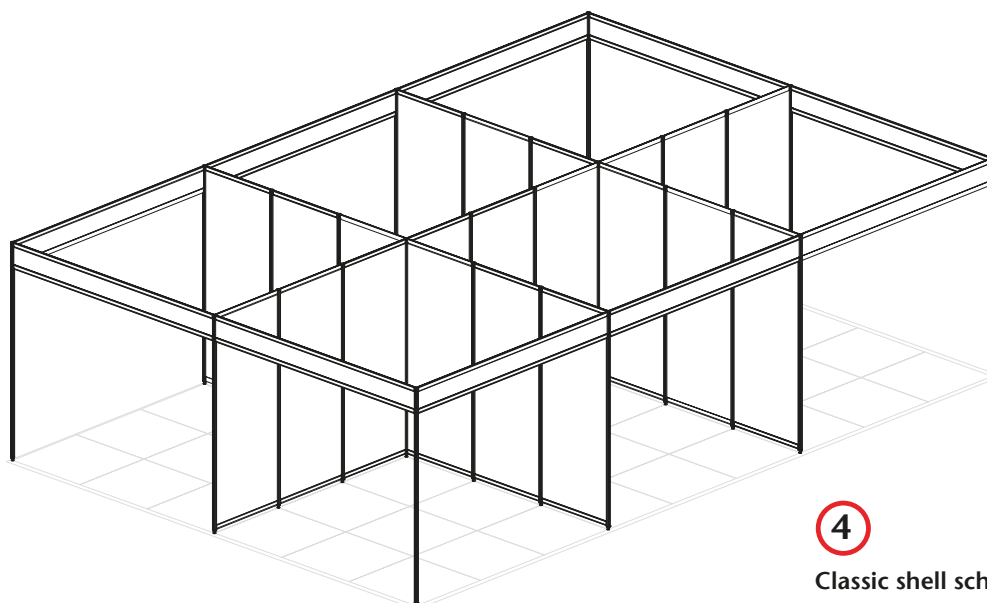

4

Classic shell schemes in an exhibition centre
Stands for rent and event.

5

Circular baldachin
Circular baldachin/frieze above
the stand suspended from the ceiling.

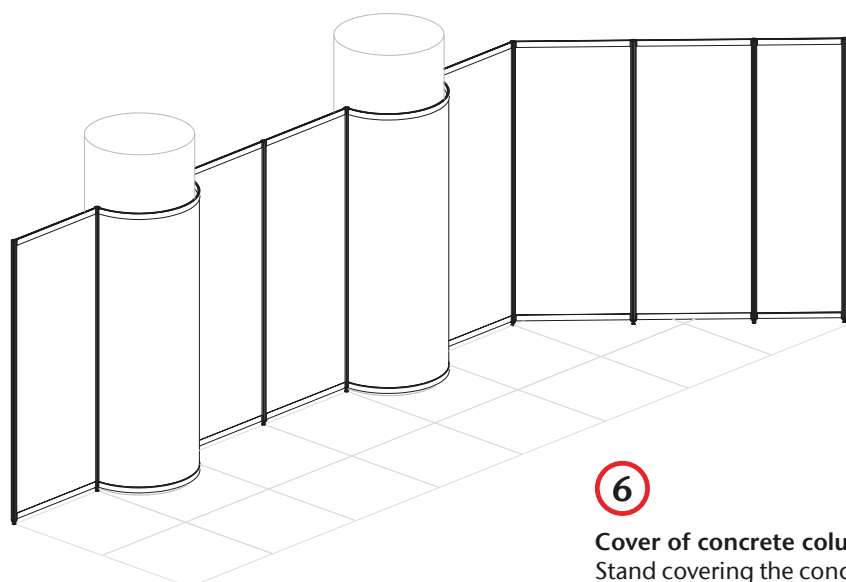
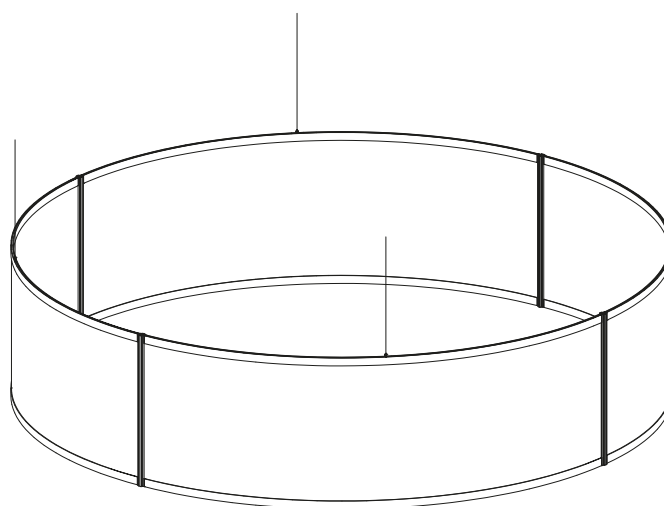

6

Cover of concrete columns
Stand covering the concrete columns of the exhibition centre.

7

Shell schemes in exhibition centres

Stands build as shell schemes can be delivered in standard modular sizes or customized. We offer accessories as spotlights, shelves etc.

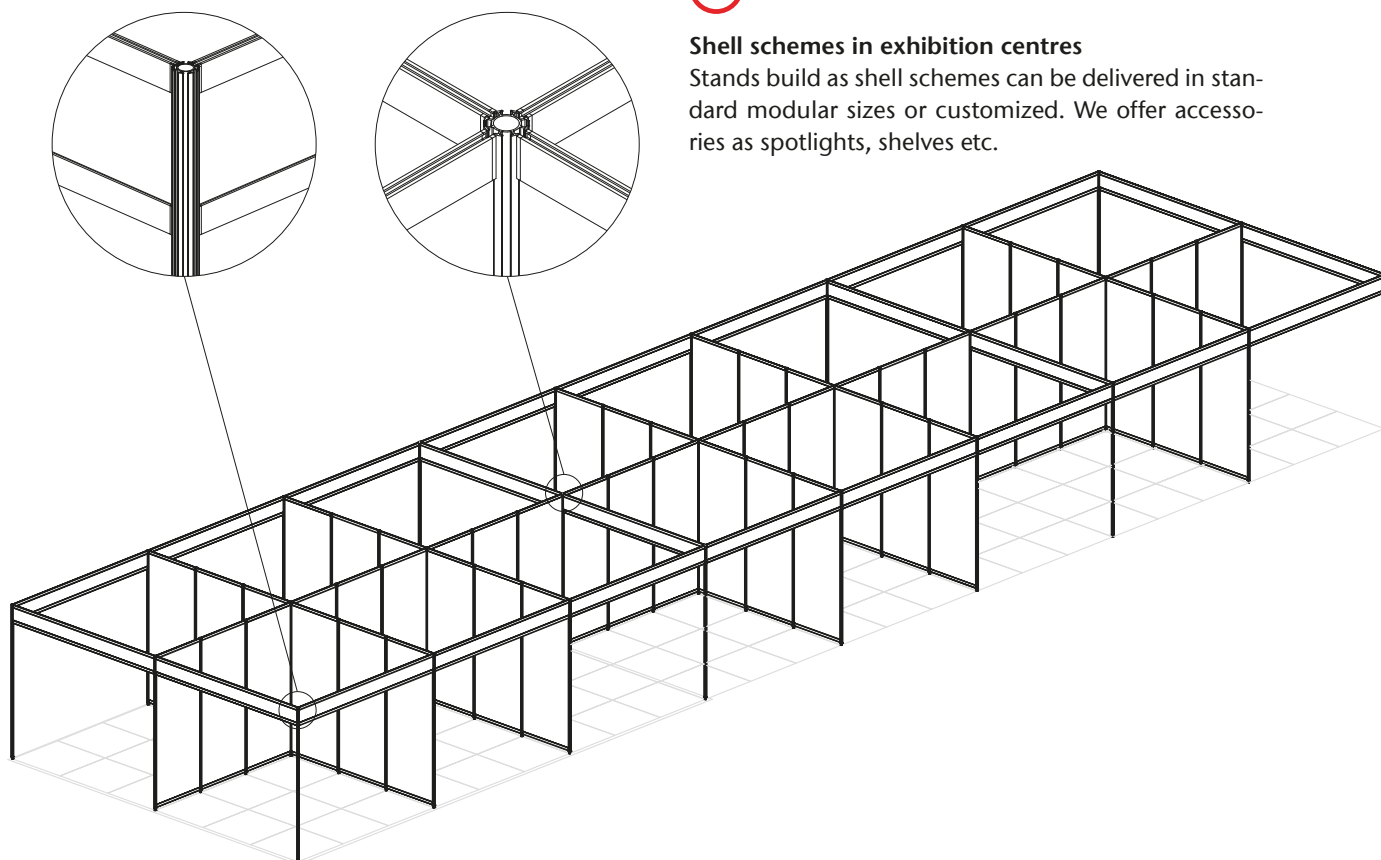

Accessories

A4 Brochure trays

Brochure trays, sign frames and shelves can be placed in all heights and on all uprights.



WS-10
Brochure tray 45°, right side



WS-11
Brochure tray 45°, left side



WS-12
Brochure tray 45°, middle

Sign frame



WS-13
A4 Sign frame

Shelf



WS-14
Shelf, Ø300 mm, 16mm white melamine.

Spotlights

Spotlights can be attached by clicking into the system.

Halogen



GDS-HSP-120
Spotlight 120W incl. GDS-bracket

LED



GDS-HSP-LED 24W
Spotlight 24W incl. GDS-bracket

Displays with fabric banner



**SYSTEM
STANDEX®**

Fabric banner are an economic method of presenting large (and small) scale graphics. The fabric simply requires a hem top and bottom so as to take the cross rails. The banner will stretch between the cross rails when fitted to the uprights. The system can be used as part of the exhibition stand or as a stand alone display. See our range of uprights on page 8 and 14.

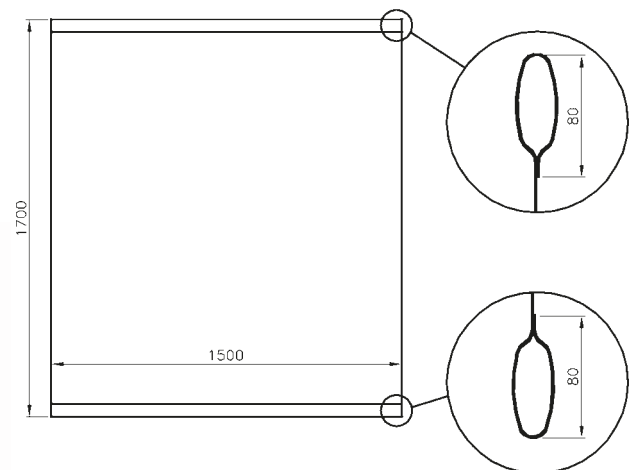

Material to have a hem top and bottom to take cross rails.

Base plate

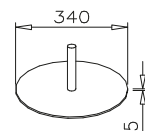

WSF-44
Base plate Ø340mm

Completed cross rails

Cross rails complete with connectors – stretch fabric graphics or support between uprights.



WS-22
2 piece cross rail,
50mm, length 1800mm.

WS-22-S
2 piece cross rail,
50mm, specify length.



WS-26
50mm cross rail,
length 1800mm.

WS-26-S
50mm cross rail,
specify length.

Cobra Expo

Module size

The cross rails are to modular lengths of 984mm between the centre of uprights. This ensures that there is room for complete modules in a stand which has been measured in full metres.

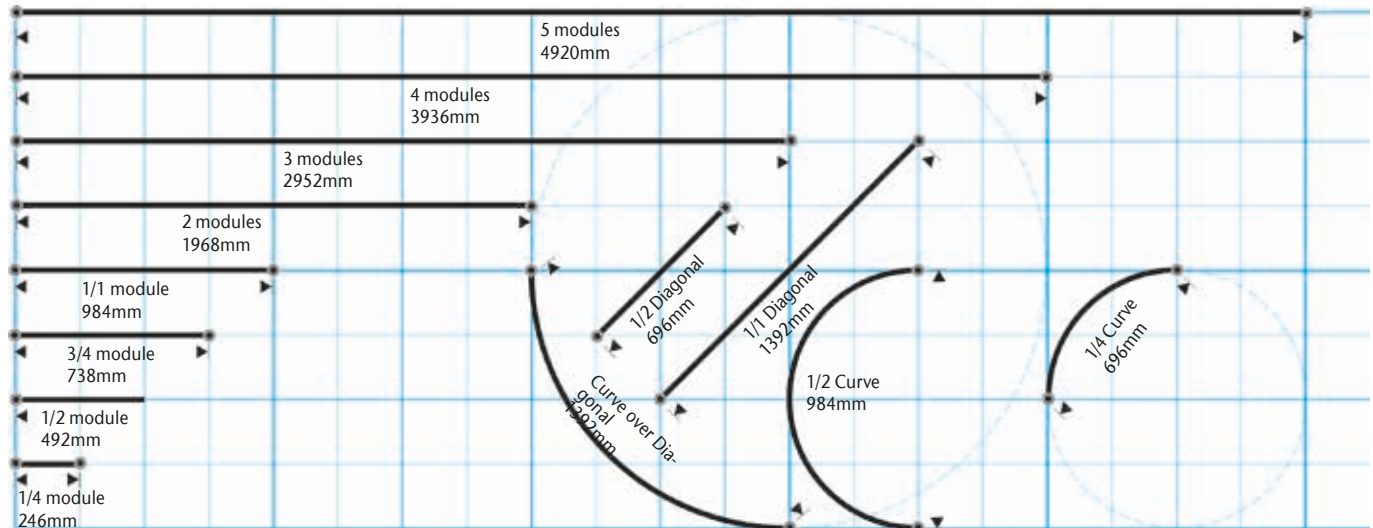

Measurements for cutting panels

In the table you can see the final panel measurements for the most commonly used combinations of cross rails and uprights. Panels should be cut to an accuracy of $\pm 2\text{mm}$.

Length of upright incl. adjustable foot			2500mm	2450mm	1000mm	700mm	500mm	Sign friezes 300mm
		Height of cross rails						
Length of cross rails	1/4 module	2 x 50mm 50 + 150mm	214 x 2374 214 x 2274	214 x 2324 214 x 2224	214 x 874	214 x 574	214 x 374	214 x 214
	1/2 module	2 x 50mm 50 + 150mm	460 x 2374 460 x 2274	460 x 2324 460 x 2224	460 x 874	460 x 574	460 x 374	460 x 214
	3/4 module	2 x 50mm 50 + 150mm	706 x 2374 706 x 2274	706 x 2324 706 x 2224	706 x 874	706 x 574	706 x 374	706 x 214
	1/1 module	2 x 50mm 50 + 150mm	952 x 2374 952 x 2274	952 x 2324 952 x 2224	952 x 874	952 x 574	952 x 374	952 x 214
	2 modules	2 x 50mm				1936 x 574	1936 x 374	1936 x 214
	3 modules	2 x 50mm				2920 x 574	2920 x 374	2920 x 214
	4 modules	2 x 50mm				3904 x 574	3904 x 374	3904 x 214
	5 modules	2 x 50mm				4888 x 574	4888 x 374	4888 x 214
	1/2 diagonal	2 x 50mm 50 + 150mm	664 x 2374 664 x 2274	664 x 2324 664 x 2224	664 x 874	664 x 574	664 x 374	664 x 214
	1/1 diagonal	2 x 50mm 50 + 150mm	1360 x 2374 1360 x 2274	1360 x 2324 1360 x 2224	1360 x 874	1360 x 574	1360 x 374	1360 x 214
	Curve over diagonal	2 x 50mm 50 + 150mm	1515 x 2374 1515 x 2274	1515 x 2324 1515 x 2224	1515 x 874	1515 x 574	1515 x 374	1515 x 214
	1/2 curve	2 x 50mm 50 + 150mm	1528 x 2374 1528 x 2274	1528 x 2324 1528 x 2224	1528 x 874	1528 x 574	1528 x 374	1528 x 214
	1/4 curve	2 x 50mm 50 + 150mm	774 x 2374 774 x 2274	774 x 2324 774 x 2224	774 x 874	774 x 574	774 x 374	774 x 214

See the complete program of Cobra Expo with article pages 8-11.

Other brochures



EASYLOCK-1
Modular system for fabric banners in large sizes



EASYLOCK-2
Modular system for fabric banners in modular sizes



EASYLOCK-3
Modular system for panels with magnets



Profile system for fabric graphics
Frames for fabric graphics – with or without LED illumination

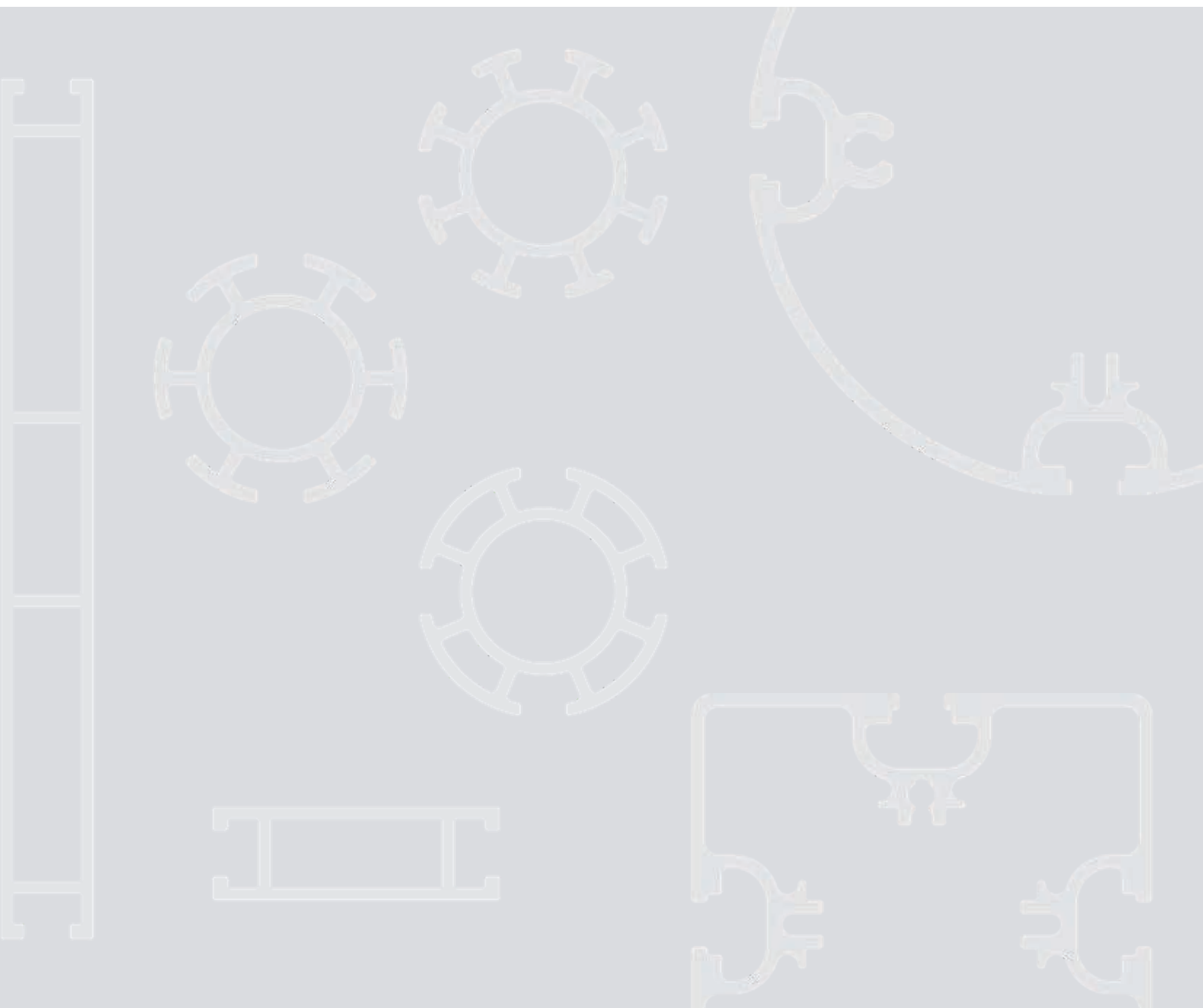

For more information contact us at:

SYSTEM STANDEX A/S

Herluf Trolles Vej 140 · 5220 Odense SØ · Denmark

Tel.: +45 66 15 66 15 · Fax: +45 66 15 55 48

info@system-standex.dk · www.system-standex.com



**SYSTEM
STANDEX®**